

REHABILITATION OF THE FORMER FACILITIES OF THE ETPC/CANTANHEDE CULTURE HOUSE

2016

Location

Cantanhede, Portugal

Client

Municipality of Cantanhede

Estimated Cost

849 000 EUR

Stage

Public Call for Tenders

Area

1620 m²

The cultural complex under study is composed of two buildings: the Culture House and the facilities of the former Technical and Professional School of Cantanhede (ex-ETPC).

The proposal focuses on the formal and programmatic rehabilitation of this complex, privileging integration into the surrounding urban structure and the creation of a renovated urban front in this entrance to the city, as demonstrated by the reinforcement of the physical and visual relationship between the buildings and the adjacent square.

The ex-ETPC building stands as the scenic background of the Pedro Teixeira Square. Here the plan proposes the demolition of the nascent front, and the design of a new volume with a more contemporary, light and appealing aesthetic that welcomes those arriving at the city: a glazed cubic volume encased in steel frames that accommodates the new Tourist Office. The rest of the building is refurbished on the inside, while maintaining and formally upgrading its current volumetry and fundamental pre-existing facade elements – an arch and a walkway.

TOURIST OFFICE

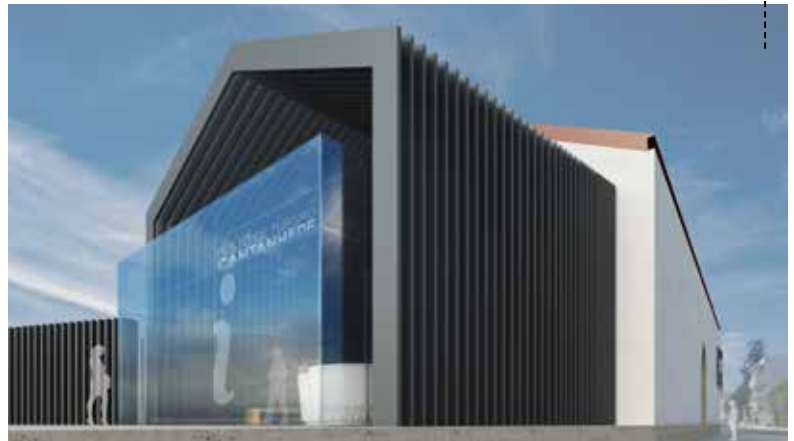

MAIN FACADE





EXHIBITION AREA

The intervention on the Culture House focuses on the functional reorganisation of its interior and on the renovation of existing interior and exterior elements, given its good state of conservation and its classified historical and architectural character.

The project also contemplates the rehabilitation of outdoor spaces, creating a backyard that can host recreational and cultural events, with a garden and a raised platform that serves both as a terrace and as the stage of a small outdoor amphitheatre.

BACKYARD

