

INTEGRATED URBAN PLANS OF CAPALANCA LAND RESERVES OF CACUACO AND LUANDA NORTE

2010

Location

Capalanca, Cacuaco/Luanda Norte, Angola

Client

IPGUL - Instituto do Planeamento e Gestão Urbana de Luanda

Estimated Cost

35 billion EUR

Stage

Urban Plan

Area

23 453 ha

The integrated urbanisation plans of Capalanca were part of an emerging territorial structure, whose goal was to promote Luanda as a “global city”.

The purpose of this design was to give a set of essential urban features to the population, among which: employment and economic boost; increase of the housing stock; population rehousing; effective mobility and transport networks; improvement of the health and education systems; a greater variety of spaces dedicated to culture and to leisure; quality of life and modernity.

The present occupation plan was based on the Angolan government’s strategy for resolving the lack of housing stock in Angola, especially in Luanda, where three fourths of the population are still living in low-grade houses.

The implementation of the urbanisation plans will be phased, with a projected conclusion date of 2035. In a first phase, construction of social housing will be the priority, in order to provide dignified living conditions to the population as immediately as possible. In the following phases, greater emphasis will be given to other types of habitation markets.

URBAN CENTRE



CENTRAL HOSPITAL



URBAN AVENUE



URBAN ENVIRONMENT



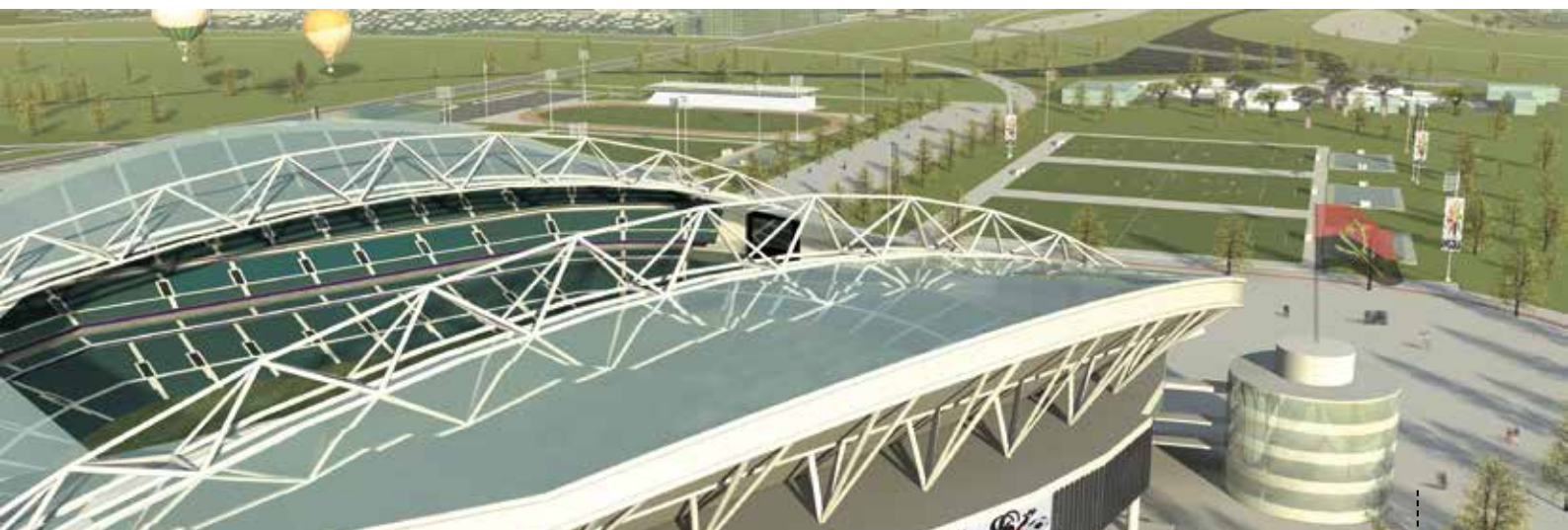

SPORTS COMPLEX

While implementing this plan, we sought to ensure the sustainable urban development of the new expansion areas of Luanda and provide an urban environment of exceptional quality in which to work and to live.

Thus, a set of social, cultural and commercial infrastructures, adapted to the different needs of the population were defined, as well as an effective public transport strategy, inserted into an adjusted mobility structure. A network of

public spaces and buildings capable of projecting the city into a competitive urban context was equally designed.

The Capalanca integrated urban plans, entirely designed by A1V2, demonstrate our unique ability to define strategies and accomplish large-scale projects, in articulation with the promoting and regulating local entities, that adequately meet the needs and expectations of the population.

MIXED USE BUILDING AREA



HOUSE BLOCK INTERIOR



INTEGRATED URBAN PLANS OF CAPALANCA LAND RESERVES OF CACUACO AND LUANDA NORTE

2010

Location

Capalanca, Cacuaco and
Luanda Norte, Angola

Client

IPGUL - Instituto do
Planeamento e Gestão
Urbana de Luanda

Estimated Cost

35 billion EUR

Stage

Urban plan

Area

23 453 ha

The Integrated Urban Plans of Capalanca are
located to the east of Luanda.

Due to the dimension of the intervention, its
complexity and the variety of elements to
adjust and incorporate into it, these plans are
comprised of six planning and management
operational units.

Construction works are phased into four stages,
to be implemented until 2040.

The proposal for the water supply and fire
prevention network features a maximum
diameter of 2000 mm and an approximate
length of 1430 km. The estimated cost for this
network is 350 million EUR.

LOCATION MAP

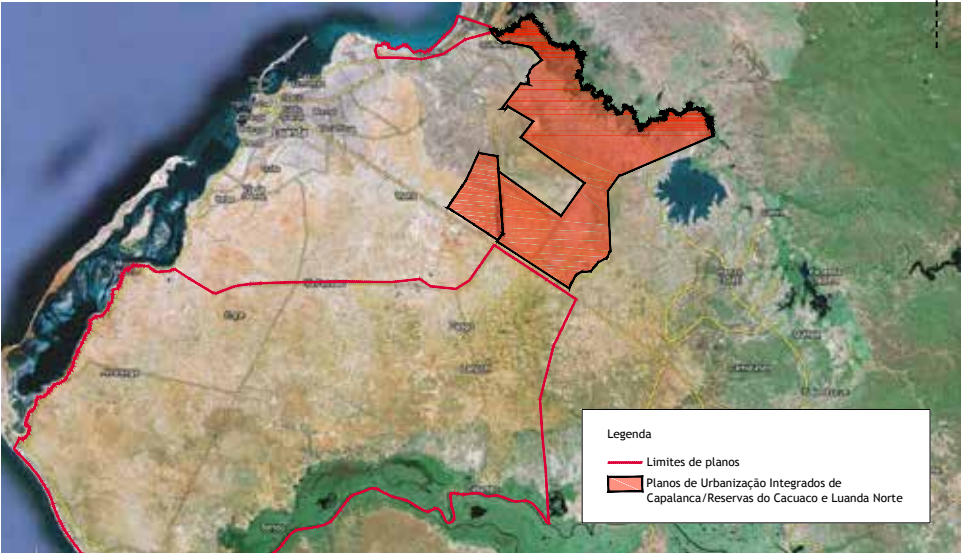

DETAIL OF THE WATER
SUPPLY NETWORK

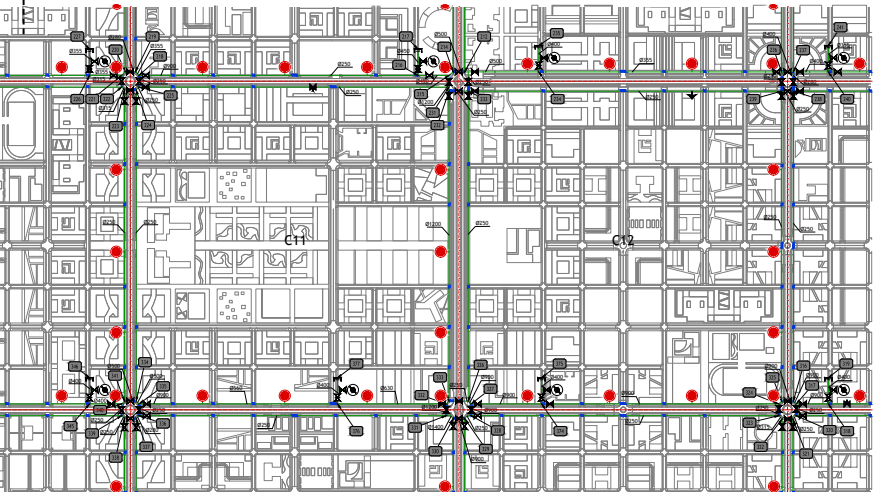

DETAILS OF
CONNECTIONS

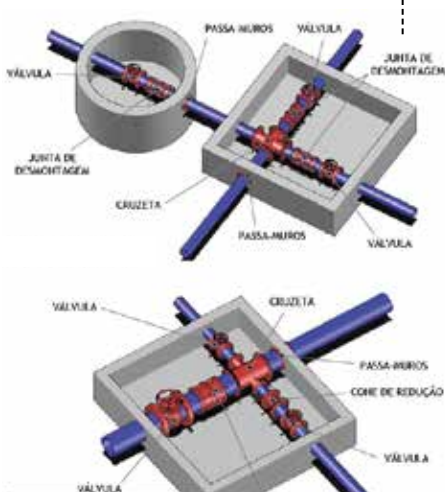

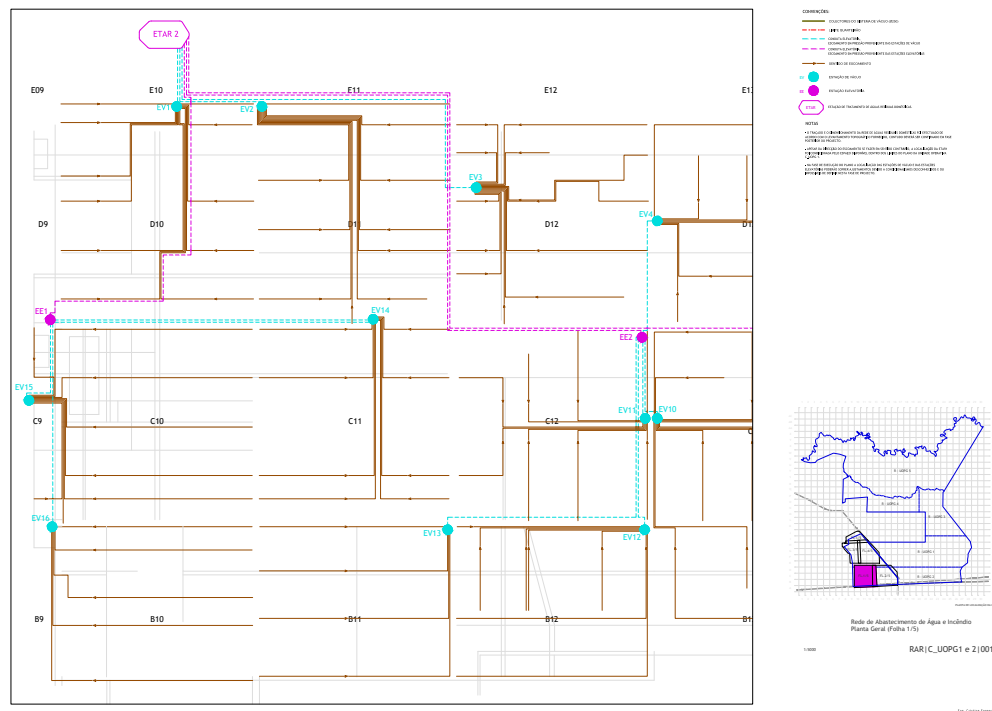

DETAIL OF THE VACUUM
SEWER SYSTEM

Given the nature of the plans and the topographical irregularities present in the terrain, a vacuum sewer system was proposed.

It includes six wastewater treatment plants, with an estimated cost of 25 million EUR each, thirteen vacuum stations, each with an average cost of 732 000 EUR, as well as twenty pumping stations, costing approximately 2.5 million EUR.

The total estimated cost for these systems is 750 million EUR.

This sewer system was sized to serve a final population of approximately 1.4 million inhabitants, the projected number to be reached until 2040.

The estimated cost of the full hydraulics system is 1100 million EUR.

MODEL OF MAINS CONNECTIONS



PUMPING STATION

